

**Install (optional) splicer bars.** If your (>140" w) screen has split top/bottom frame pieces, insert two splicer bars into one side of a top or bottom frame piece, join the other half and align the alignment pins into their holes. Push the joint snugly, center the splicer bars so that its two center holes perfectly bridge the splice and fully tighten the set screws. (Only one pictured, from our Precision frame)



**Install L-brackets.** Align the corner L-brackets into their mating slots in the other frame member, two per corner, and slide them together making a nice tight corner.

**Install short side last.** For this last piece, a short side, insert its L-brackets but do not tighten at this time. Align the four L-brackets into their mating slots into the top and bottom frame pieces and slide into position.



**Check alignment, then tighten screws.** Confirming with your fingers that the joints are aligned nicely, go ahead and tighten the remaining set screws.

**Flip the frame over,** post side up.

**Layout screen on frame.** Unroll the screen onto the front of the facing-up frame. The inside surface of the roll is what is recommended for the viewing surface. Don't worry about waves; they will be tensioned out later.



**Attach screen to frame.**

1. Pinch the o-ring.
2. Poke one end through a grommet.

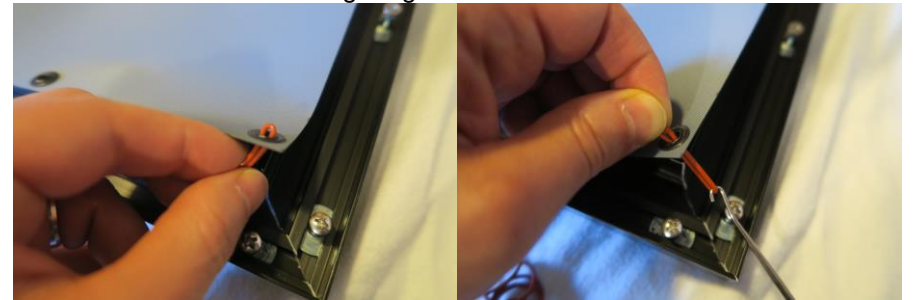

3. Hold top end you poked through, hook with bottom end with tool and loop over post.

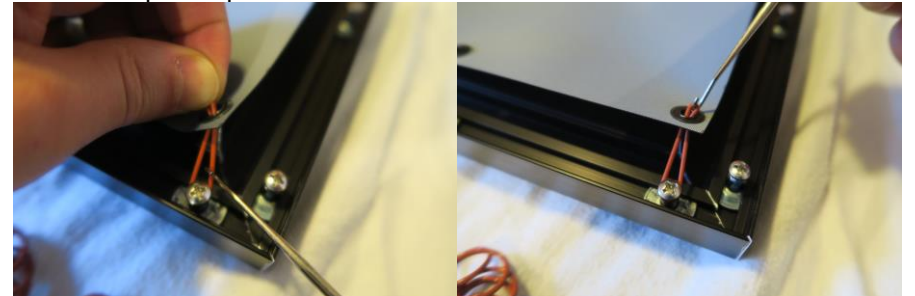

4. Hook top end with tool.
5. Pull the band taught and hook other side over the post.

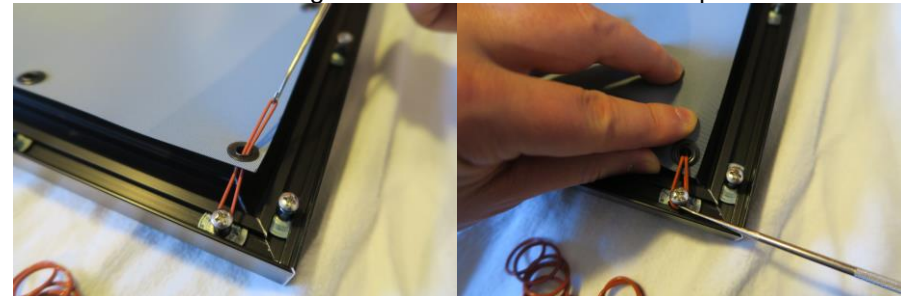

**Corner O-rings.** Use two per corner.

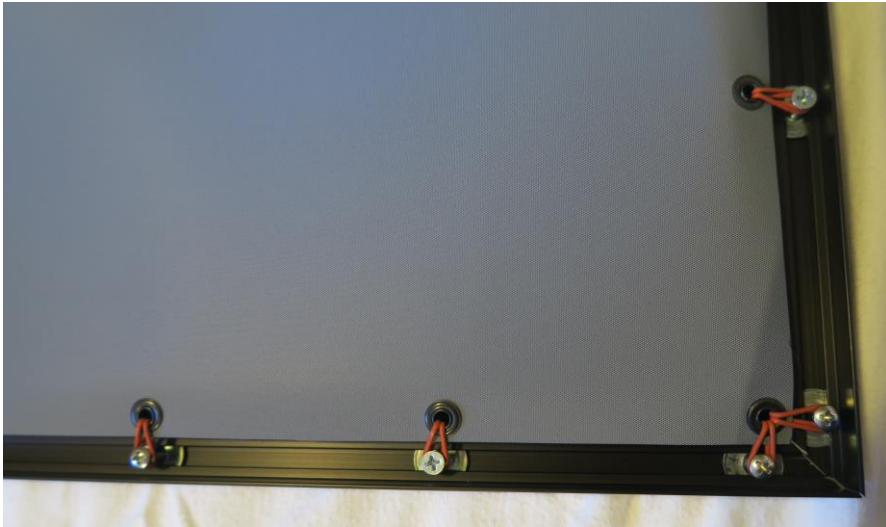

**Attach trim.** Screw the four to six, 1.5" wide velvet trim pieces using the small black screws provided and vacuum with a brush or use a lint roller on the velvet trim.

**Hang the screen.** Hang it up with two people.

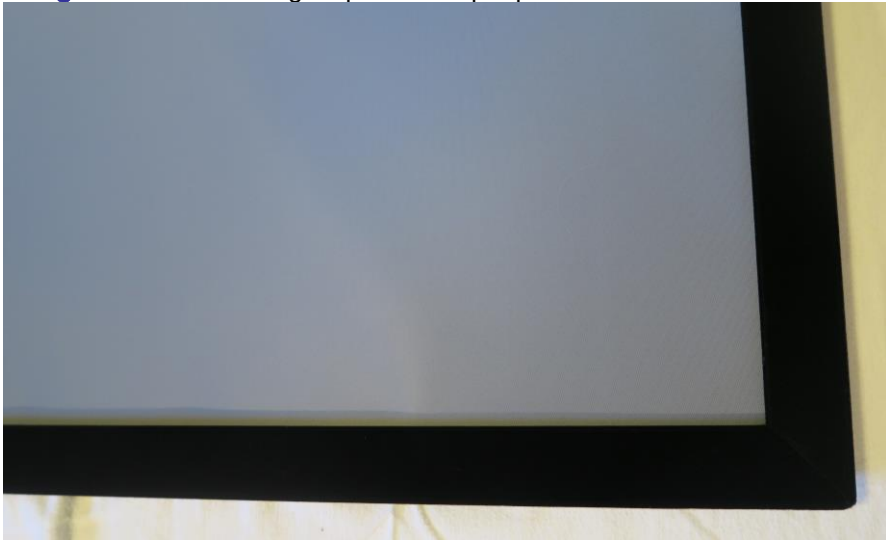

## Metro Fixed Frame Screen Assembly

### Contents:

- ☑ 4-6: Black anodized, extruded structural frame members
- ☑ 4-6: Velvet wrapped "L" trim pieces (with black screws)
- ☑ Screen, with installed grommets
- ☑ 8: Corner L-brackets (screws preinstalled)
- ☑ 4: Splicing bars (used on screens wider than 140")
- ☑ 1: 1/8" hex ball-point L-key
- ☑ O-rings (4 extra) with O-ring hook tool
- ☑ 2: Hangman brackets, with hardware

**Install wall Hangman brackets.** Mark stud locations (or plan to use the drywall anchors), and install the two Hangman brackets that came with the screen at about the  $\frac{1}{4}$  and  $\frac{3}{4}$  width dimensions. Each bracket needs **one** screw to be fully engaged into a load-bearing stud. You can drill through the aluminum as needed.



### Layout frame face down.

Setting one of the short sides aside (it will have 45 degree corners on each end), lay the frame members faced down where they will be installed, together with the corner L-brackets and splicing bars for the tops and bottoms.

